



Bury Road, Mildenhall, Suffolk, IP28 7HT

Rent - £1,485 PCM Deposit - £1,713

Stunning 4-Bedroom Family Home in Mildenhall – Perfect Location Near RAF Bases

This modern, spacious 4-bedroom home offers ideal accommodation in the heart of Mildenhall, Suffolk.

The accommodation briefly comprises of a modern fully fitted kitchen including integrated appliances, living room, dining room, and cloakroom. Upstairs the property has 4 bedrooms along with a family bathroom. This property is perfectly positioned near the RAF bases and within easy reach of local amenities, this property is perfect for families, professionals, or anyone seeking comfort and convenience.

- MODERN SEMI DETACHED HOUSE
- 4 GOOD SIZED BEDROOMS
- SEPARATE DINING ROOM
- FAMILY BATHROOM, EN-SUITE & CLOAKROOM
- ENCLOSED GARDEN, PARKING & GARAGE
- WITHIN WALKING DISTANCE TO MILDENHALL TOWN
- GAS HEATING & ENERGY RATING C
- APPROXIMATE SIZE 982 SQFT
- PETS CONSIDERED/ COUNCIL TAX BAND - D
- AVAILABLE MID JULY



Council Tax Band: D - EPC Rating: C 71

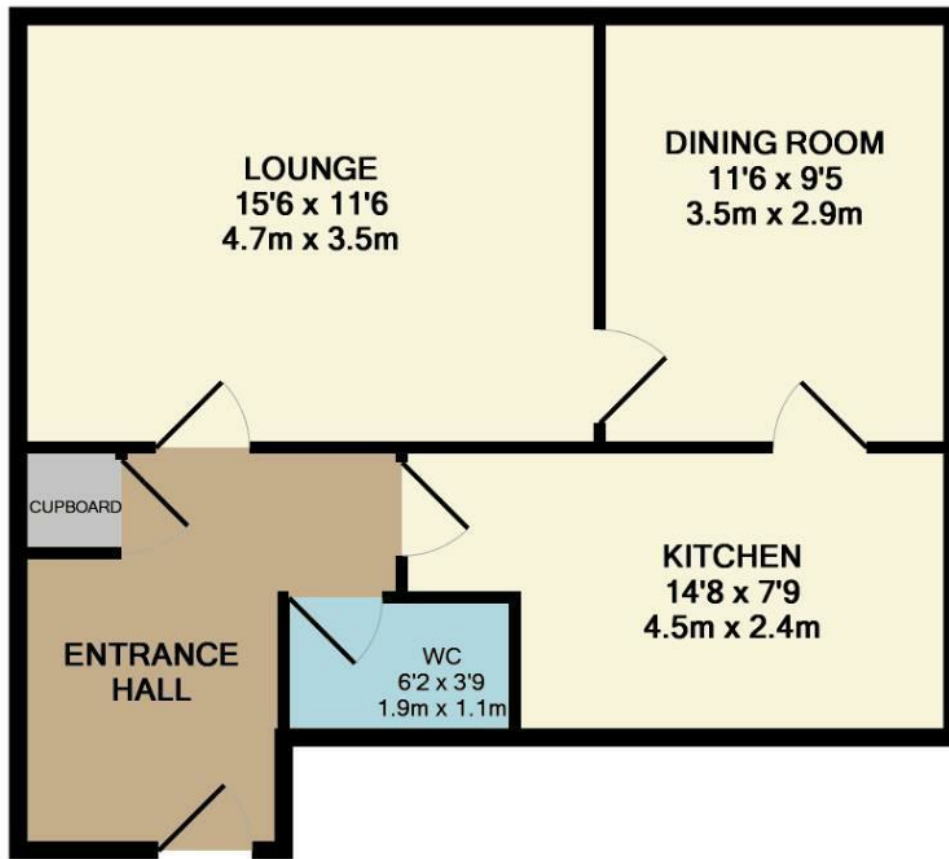

GROUND FLOOR
APPROX. FLOOR
AREA 502 SQ.FT.
(46.6 SQ.M.)

